

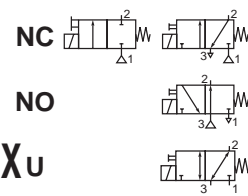

MINI-SOLENOID VALVES

non-sparking protection
 II 3G Ex nA II T6..T4, II 3D Ex tD A22 T85°C..T135°C IP65
 ISO 15218 (CNOMO, size 15) interface
 direct operated, pad mounting body, connector size 15



2/2-3/2
 Series
302
 (CFSCZN
 prefix)

FEATURES

- Mini-low consumption valves for use in potentially explosive atmospheres according to ATEX-Directive 94/9/EC
- L'attestation CE de type (INERIS 10 ATEX 3016X) est en conformité avec les normes européennes EN 60079-0, EN 60079-15, EN 61241-0 et EN 61241-1
- Compact, monobloc solenoid pilot valve with spade-plug connector type DIN 43650, form C with 9,4 mm spacing
- Version without integrated LED and electrical protection
- Universal version for vacuum operation (3/2 way)

GENERAL

Differential pressure See «SPECIFICATIONS» [1 bar = 100 kPa]
Pneumatic base ISO 15218 (CNOMO E06.36.120N, size 15)
Connection Subbase
Response time 8 - 15 ms

fluids (*)	temperature range (TS)	seal materials (*)
air or inert gas filtered at 50 µm, lubricated or not	- 25°C to + 40°C (LP2) ⁽¹⁾	NBR (nitrile) FPM (fluoroelastomer)

⁽¹⁾ LP2: see "electrical characteristics" table

MATERIALS IN CONTACT WITH FLUID

(*) Ensure that the compatibility of the fluids in contact with the materials is verified

Body PAA
Internal parts POM, PET, stainless steel and brass
Seals NBR (disc), FPM (others)
Pneumatic interface seal TPE

OTHER MATERIALS

Coil Thermoplastic PET
Enclosure with PVC cable PP (polypropylene) glass-fibre reinforced

ELECTRICAL CHARACTERISTICS

Coil insulation class F II 3G Ex nA II T6..T4
 II 3D Ex tD A22 IP65 T 85°C..T 135°C

Connector Spade plug (2m cable length)
Connector specification DIN 43650, 9,4 mm, form C
Electrical safety IEC 335
Electrical enclosure protection Moulded IP65 (EN 60529)
Standard voltages DC (=) : 24V
 AC (~) : Contact us
 (Other voltages on request)

coils		power ratings	max. ambient temperature °C ⁽²⁾			type ⁽⁴⁾
power level	voltages	hot/cold = (W)	surface temperature			
			T6 85°C	T5 100°C	T4 135°C	
LP2 ⁽³⁾	24	1 / 1,2	40	55	60	01

For versions with LED indicator and electrical protection:
 Contact us

⁽²⁾ The minimum allowable ambient temperature is -25°C.
 Actual temperature range can be limited depending on valve operation limits.

⁽³⁾ Voltage: -15% / +20%

⁽⁴⁾ Refer to the dimensional drawings on the following page.

SPECIFICATIONS

orifice size (mm)	flow				operating pressure differential (bar)		power level	basic catalogue number			
	at 6 bar l/min (ANR)		coefficient Kv		min.	max. (PS)		manual operator			
	1 → 2	2 → 3	1 → 2	2 → 3				impulse		maintained	
	1 → 2	2 → 3	1 → 2	2 → 3				~	=	~	=
2/2 NC - Normally closed (Without LED and protection)											
1,5	39	-	0,50	-	0	3	LP2	-	30211022NAD	-	30211023NAD
3/2 NC - normally closed (Without LED and protection)											
0,6	11	20	0,11	0,26	0	10	LP2	-	30211109NAD	-	30211110NAD
0,8	17	28	0,22	0,35	0	8	LP2	-	30211112NAD	-	30211113NAD
1,1	32	51	0,35	0,50	0	5	LP2	-	30211118NAD	-	30211119NAD
1,5	39	53	0,50	0,56	0	3	LP2	-	30211124NAD	-	30211125NAD
	3 → 2	2 → 1	3 → 2	2 → 1							
3/2 NO - normally open (Without LED and protection)											
0,8	20	17	0,26	0,20	0	8	LP2	-	30211130NAD	-	-
1	28	32	0,35	0,35	0	5	LP2	-	30211136NAD	-	-
1,5	53	39	0,56	0,50	0	2	LP2	-	30211142NAD	-	-
	1 ↔ 2	2 ↔ 3	1 ↔ 2	2 ↔ 3							
3/2 U - universal (Without LED and protection)											
0,8	17	20	0,20	0,26	0	6	LP2	-	30211148NAD	-	30211149NAD

When ordering, please specify, in addition to the basic catalogue number, the type of current: voltage

Examples: 24V DC: **30211009NAD** 24V DC

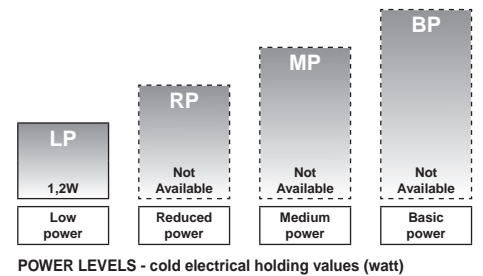
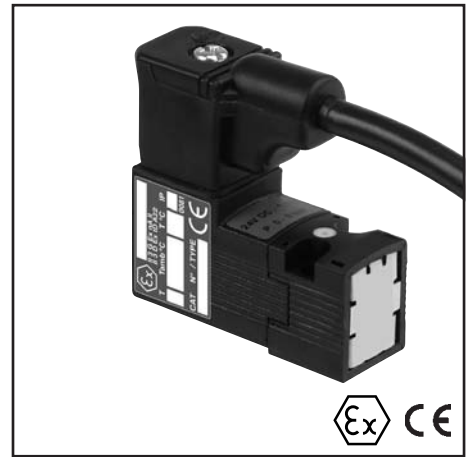

POWER LEVELS - cold electrical holding values (watt)

OPTIONS AND ACCESSORIES

- Seals and disc made of FPM (fluoroelastomer)
- Version without manual operator
- Version with pneumatic-electric interface

INSTALLATION

- Multi language installation/maintenance instructions are included with each valve
- The solenoid valves can be mounted in any position without affecting operation
- **Pre-wired connector, supplied and certified with the product (DIN 43650, 9,4 mm, form C, with 2 m cable length). For connection, only use the connector supplied with the product**
- Solenoid valve supplied with mounting screws and mounting pad seal(s)

DIMENSIONS (mm), WEIGHT (kg)



TYPE 01:
CFSCZN
302 pilot
Polyarylamide
IEC 335 / DIN 43650

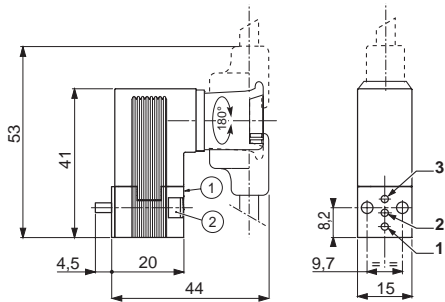

- ① Manual operator location
- ② 2 mounting screw M3 x 20

function	connection		
	1	2	3
2/2 way			
	NC	P	U
3/2 way			
	NC	P	U
	NO	E	P
universal	MIX	P2	U
	SEL	U 2	P
		U	P1
		P	U 1

P: Pressure U: Outlet
E: Exhaust

Subbase mounting surface: ISO 15218
(CNOMO E06.36.120N, size 15)

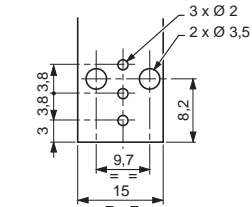

weight ⁽¹⁾
0,14

⁽¹⁾ with connector.

Single subbase Aluminium or brass

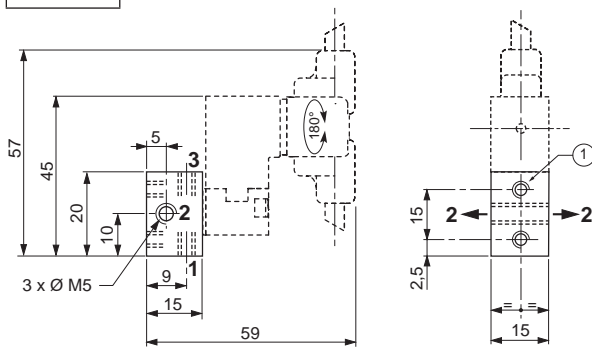

- ① Mounting: 2 holes M3, depth 4,5
- Orifice (2) can be connected on the left or on the right of the subbase.

material	catalogue number	weight ⁽¹⁾
aluminium	88263002	0,011
brass	30300001	0,034

⁽¹⁾ subbase alone

Adapter CNOMO size 30 (only for NC version) Aluminium

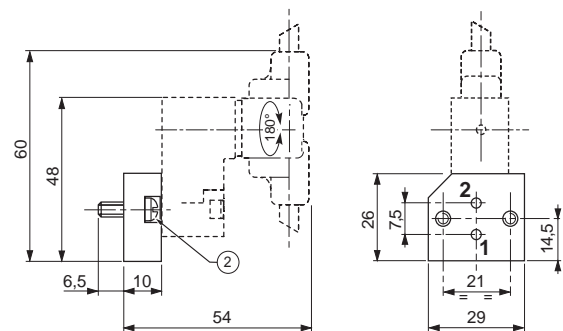

- ② Mounting: 2 screws M4 x 10 (supplied)

catalogue number	weight ⁽²⁾
88263001	0,018

⁽²⁾ adapter alone